

## 200W LED Profile Spot Light

VG-ERS200A(3200k/5600k)



CE RoHS

## User Manual

 Please read this user manual before using this product!

Keep it for further reference!

<http://www.vangaa.com>

## INDEX

<b>I INTRODUCTION.....</b>	<b>01</b>
<b>II DESCRIPTION OF THE DEVICE .....</b>	<b>02</b>
<b>III INSTALLATION.....</b>	<b>05</b>
<b>IV OPERATION .....</b>	<b>10</b>
<b>V APPENDIX .....</b>	<b>12</b>

Thank you for using our product! Please read this manual carefully and completely. For technical reference in future, please keep this user manual well. This user manual contains all installation and operation information of this LED Profile Spot Light, it's very useful for user to install and operate the light. Please strictly abide by the relevant instruction for the installation and operation.

This light has very beautiful appearance. This is a professional LED Fixed Lens Profile Spot Light. It uses high CRI and high power LED integrated lamp (COB lamp) as the light emitting element. So the light has high light efficiency, good color rendering, low glare value, long lifespan, energy conservation, environmental protection and other advantages. The light has high brightness, uniform light, which is very suitable for meeting room, studio and other places. Using DMX signal to realize the linear dimmer, more convenience. This light is saving energy and protecting environment, pure color temperature, it is a very suitable substitute of the traditional 750 profile light.

This light meets the following criteria:

GB7000.1-2007/IEC60598-1:2003

GB7000.217-2008/IEC60598-2-17:1984+A2:1990

## I INTRODUCTION

Thank you for having chosen our 200W led profile spot light. You will see you have acquired a powerful and versatile device.

Unpack your 200W led profile spot

Delivery includes

200W LED Profile Spot Light      1pc

Gobo frame	1pc
DMX cable	1pc
Power cable	1pc
User Manual	1pc

## II DESCRIPTION OF THE DEVICE

### 1. Profile

With the idea of energy saving and environment protection, the device use lower power loss and extremely high efficiency led. The device housing cover is made of used the new high strength heat resistance engineering plastics, with beautiful shape and smooth lines. The designing and manufacturing is in compliance with IEC standard. The device is suitable in the large-scale theatrical performance, the theater, the performance hall, the bar night club and so on.

### 2. Overview

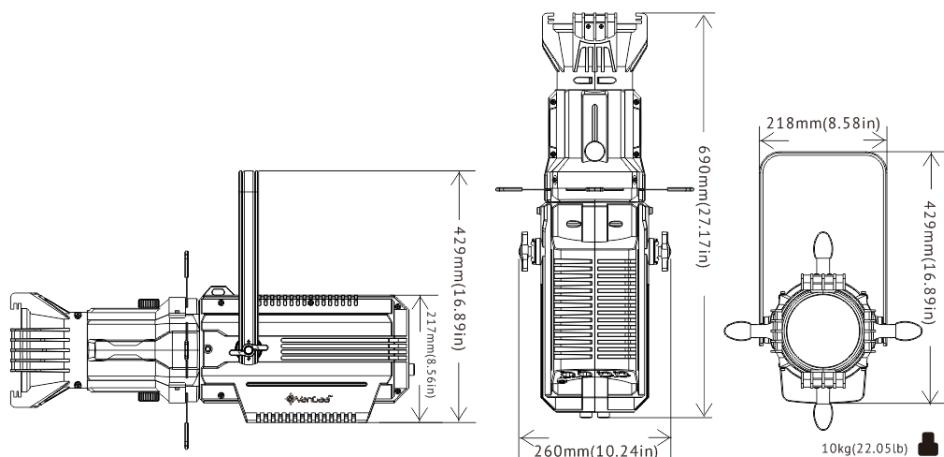

All dimensions are in millimeters

### 3. Specification

Light source: 200W LED

Power supply: AC100V-240V, 50/60Hz

Power consumption: 200W

DMC Chanel: 1CH

Color temperature: 3200K/5600K

CRI: Ra $\geq$ 95

Fan speed automatic detection system

Small volume, light weight

High quality optical system

Different lens available (14°/19°/26°36°/50°)

Net weight: 10.5kg

### 4. Photographic chart

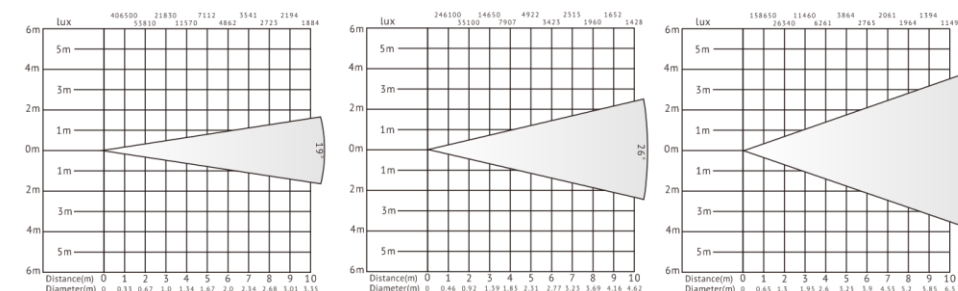

### 5. Safety warning

#### ① Warning:

- Every person involved with the installation, operation and maintenance of this device has to be qualified
- User must follow the instructions of this manual
- Unqualified person cannot open the housing cover and operate the device, or the dealer will not accept liability for any result defects or problems.

- The device against rain and moisture

## ② Warning note

- Power Supply AC100v-240v,50HZ/60HZ
- Make sure the power switch is off, the power plug, outlet and the earth connection is in well condition before connecting the device with the mains
- Please use qualified power plug and outlet. Never connect the power cord of this device with other electrical equipment.
- During move and installation. make sure the device not crashed with metal parts and other materials
- Always disconnect from the mains, when the device is on installation and dismantled
- The minimum distance between light-output and the illuminated surface must be more than 50cm
- The device must only be installed on a non-flammable surface. In order to safeguard sufficient ventilation, leave 50 cm of free space around the device. Please note that heat-sensitive objects may be deformed or damaged by the emitted heat.
- During the operation the housing becomes very hot! Do not operate the device for 15 minutes after switching off.
- The maximum ambient temperature  $T_a-45^{\circ}\text{C}$  must never be exceeded. The maximum housing temperature  $T_b-80^{\circ}\text{C}$  must never be exceeded
- For indoors use
- Replace any visible cracked protective shield, filter and lens
- The protective shield, filters and lens will require weekly cleaning as smoke "fluid tends to building up to residues, reducing the light" Can put very quickly.

## III INSTALLATION

### 1. Installation

- When installation, keep the device far away the heat sensitive objects and explosives sensitive objects, leave at least 50cm of free space around the device.
- When installation, keep the device far away the heat sensitive objects and explosives sensitive objects, leave at least 50cm of free space around the device.

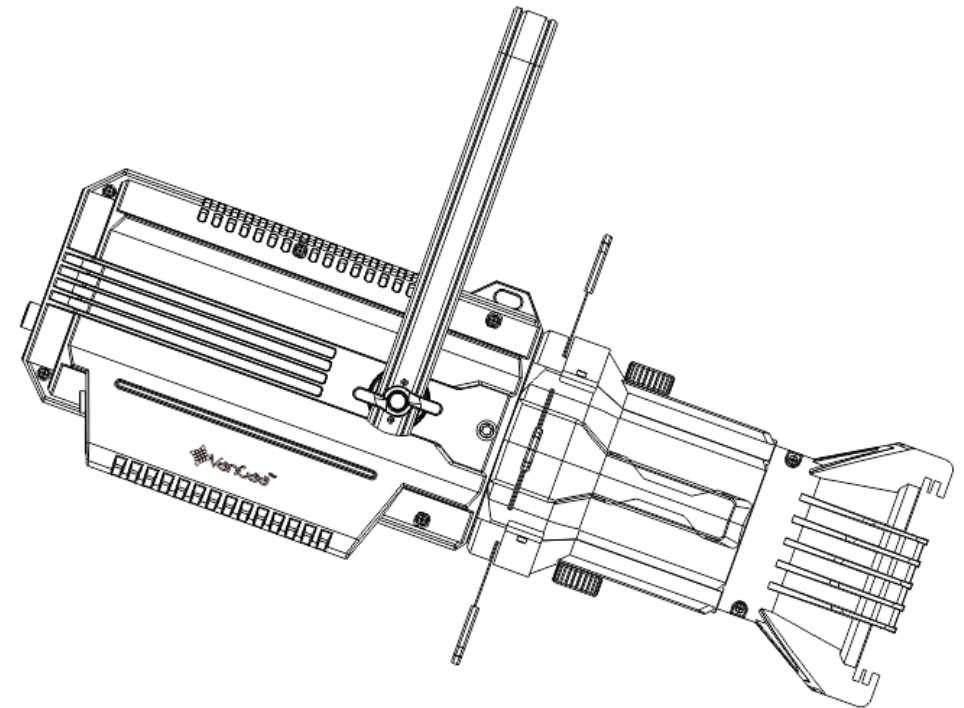

- When rigging the devices on the truss and the head face to the floor. Insert the quick-lock fasteners of the first mounting holder into the respective holes on the bottom of the device. Tighten the quick-lock fasteners fully clockwise. Install the second mounting holder. And the safety rope must be used at same time.

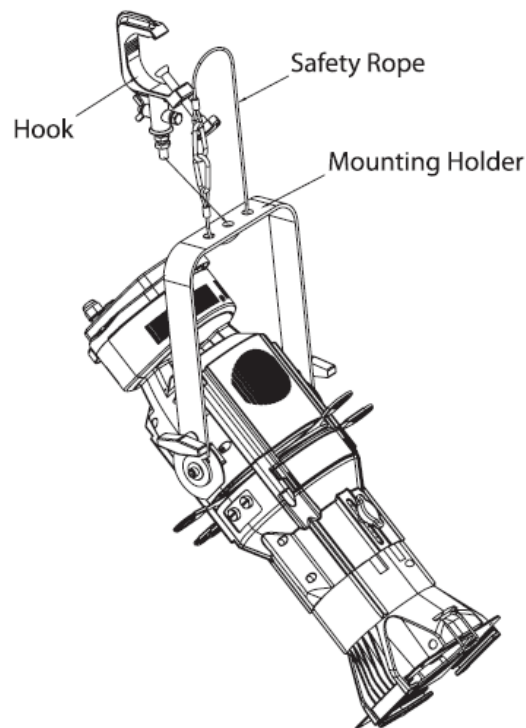

- Please use qualified safety-rope, which can hold at least 10times the weight of the fixture. You must only use only safety-ropes with quick links with screw cap. Pull the safety-rope through the hole on the bottom of the base and over the trussing system etc. Insert the end in the quick link and tighten the fixation screw. A safety rope which already hold the strain of a crash or which already hold the strain of a crash or which is defective must not be used again

## 2. Dmx512 Connection

- Please use xlr-xlr wires connect the dmx out put of the controller with the dmx input of the first device, and connect the DMX output of the first device with the dmx input of the second device, always connect one output with the input of the next device until all devices are connected.

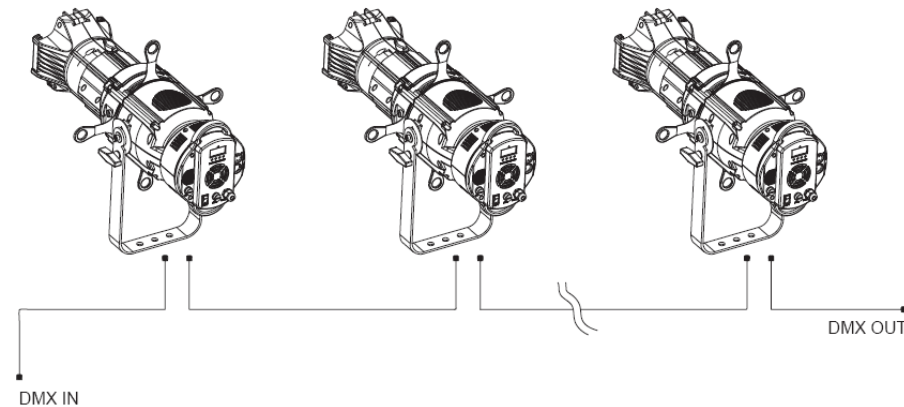

- Please use qualified xlr-xlr dmx cables

## 3. Connection with mains

- The person involved with the power connection must be qualified, and has the electrical engineering certificate.
- Connect the device to the mains with the power plug.
- The earth has to be connected.
- Power consumption 100w, input power supply ac100v-240v, 50/60HZ.

## 4. The use of color mains

- Take out the color frame. Loose the screws insert the color and lock the screws again
- Insert the color in the slot

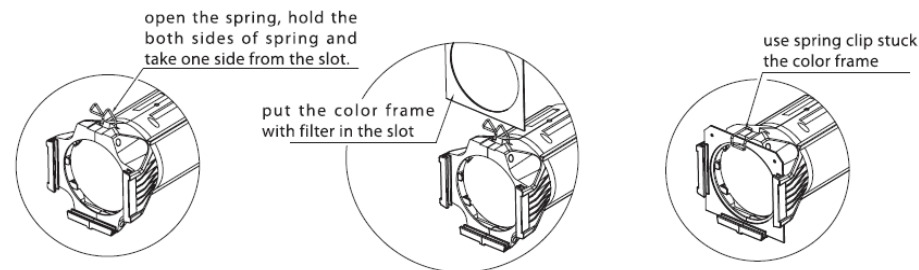

## 5. The use of gobo frame

- Take out the gobo frame ,loose the screws, insert the gobo and lock the screws again
- Insert the gobo in the slot

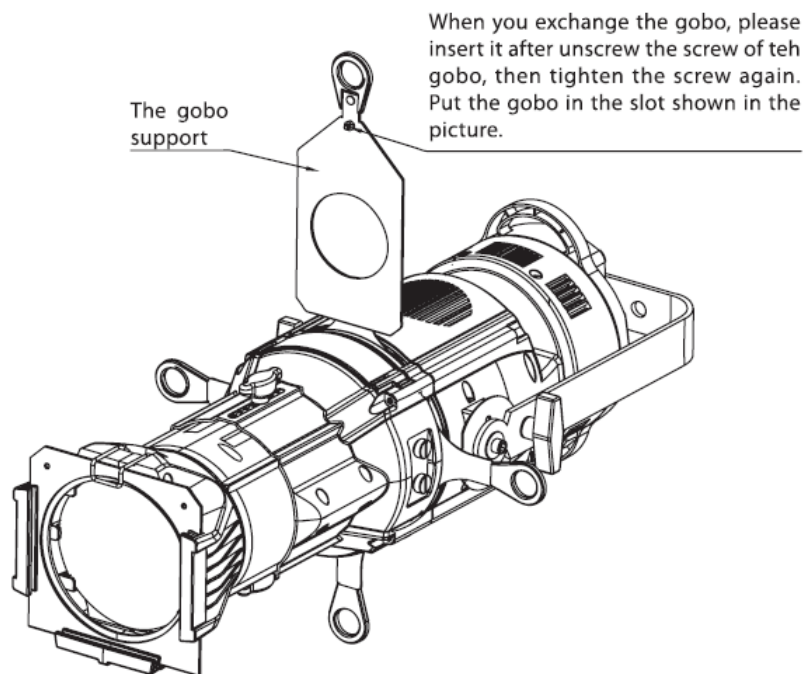

## 6. Use iris

Iris is not included when the projector leave factory, user can purchase the iris if needed  
Loose the screws and insert the iris.

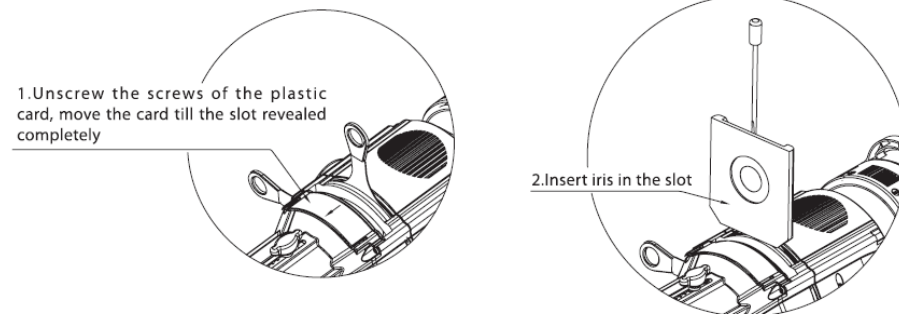

## 7. Replacing fuse

- Before replacing the fuse, unplug mains lead.
- Procedure:

Step1: Unscrew the fuse holder on the rear panel with a fitting screwdriver from housing (anti-clockwise)

Step2: Remove the old fuse in the fuse holder

Step3: Install the new fuse in the fuse holder.

Step4: Replace the fuse holder in the housing and fix it.

## 8. Focus

- The objective lens cylinder is usually shrunk before leaving factory after connect the projector to the mains, user may loose the screws and pull out the lens cylinder, till the white light output circular is clearly presented, locking tightly the two screws again.
- When the projection distance is changed, user can follow previous operating steps and focus the projector.

Unscrew the screws of the lens, move the lens in perfect position, tighten the screws of the lens again.

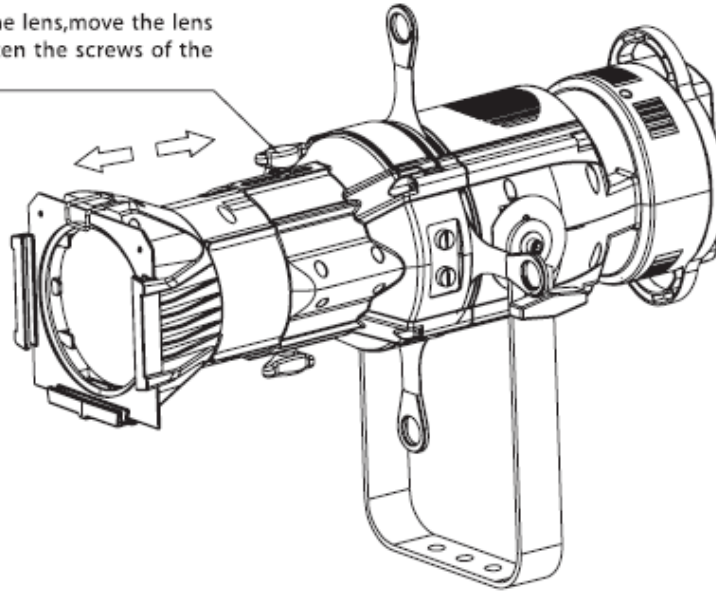

## IV OPERATION

### 1. Description of the keys

- **SET.**
- **UP.**
- **DOWN.**
- **ENTER.**

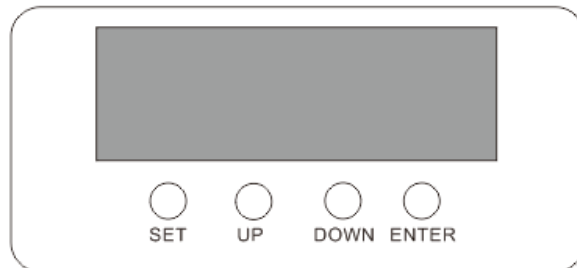

### 2. Menu

LCD SHOW	Function Instruction	Operation of Buttons	Supplementary Instruction
T=xxx°C	<ul style="list-style-type: none"> <li>◆ The temperature of LED bulb radiator in real time (Celsius)</li> <li>◆ If there is no this temperature shows, means the temperature sensor failure</li> <li>◆ If the value over 80, please check the wind path is normal or not</li> </ul>		
No Signal	Couldn't receive the DMX 512 signal		
RX DMX	<b>Received the DMX 512 signal</b>		
Address	Address setting	Press <b>UP</b> , <b>DOWN</b> button to set the address you need, then press <b>ENTER</b> to save.	
Mode	Working mode option Mode = DMX Mode = Alone scene ↓ Set alone scene Dimmer, dimmer=0-255	Press <b>UP</b> , <b>DOWN</b> button to choose the menu you need, then press <b>ENTER</b> to save.	

### 3. Basic setting

#### SETTING DMX 512 MODE

Press **ENTER** when the display show the title information;

Press **UP/DOWN** to choose the **Mode** menu, then press **ENTER** into;

Press **UP/DOWN** to choose **01 Channel DMX** or **01 Chanel DMX** menu, then press **ENTER** to save;

Press **MENU/SET** back the title mode(the second line will shows **01CH** or **01CH** **Address=001**), the setting is ok.

#### SETTING POWER ON, LIGHT ON

Press **ENTER** when the display show the title information;

Press **UP/DOWN** to choose the **Mode** menu, then press **ENTER** into;

Press **UP/DOWN** to choose **Alone scene** menu, then press to save;

Press **UP/DOWN** to choose **Set auto mode Color Temperature** menu, then press **ENTER** into the option of color temperature;

Press **UP/DOWN** to choose **Set auto mode Dimmer** menu, then press **ENTER** into the adjust function of the LED;

Press **UP/DOWN** to adjust the brightness (=000 light off, =255 Max brightness), after the setting, press **ENTER** to save;

Press twice **MENU/SET** button to back the title mode(the second line will shows **Master** **Auto**), the setting is ok.

\*The sound active mode based on the light has the sound active mode or not, this is a option function. Please contact sales manager when you need it.

### 4. DMX channel chart

CHANNEL	DMX VALUE	FUNCTION
CH1	000←→255	Linear dimmer, 0-100%

## V APPENDIX

### Problem and solution

Problem	Reason	Resolution
---------	--------	------------

Device not work	No power	AC100-240V, 50/60Hz Check the power connection, and make sure device connect the mains in well condition. Check if the switch is on. Check if the fuse is good.
LED Bulb is off	LED bulb damaged	Replacing LED bulb
	LED drive board damaged	Replacing LED drive board
	Temperature switch damaged	Replacing temperature switch
Fans not work	Fans damaged	Replacing fans

### Caution

- Unqualified person involved with installation, operation and maintenance of this device is prohibited
- If any above mentioned problem happened, or unknown problem happened, please contact manufacturer or distributor for assistance.

Please keep this manual as a reference.

Thanks again for your business. We truly appreciate it!